

100  
0 10  
A1

DO NOT SCALE

- DESIGN NOTES:**
- FOR TYPICAL CROSS SECTIONS REFER TO DRAWINGS 5155640/HTR/SCD/0015 AND 5155640/HTR/SCD/0020 - 0022.
  - FOR FLAT TOP RAMP DETAILS REFER TO 5155640/HTR/SCD/0008.
  - FOR GATE DETAILS REFER TO 5155640/HTR/SCD/0011 - 0013.
  - FOR SURFACE TRANSITION / JOINT DETAILS REFER TO 5155640/HTR/SCD/0015.
  - FOR SURFACE TYPE A AND TYPE B EDGE DETAILS REFER TO 5155640/HTR/SCD/0020

- GENERAL NOTES**
- ALL DIMENSIONS ARE IN MILLIMETRES UNLESS NOTED OTHERWISE
  - ONLY WRITTEN DIMENSIONS SHALL BE USED. NO DIMENSIONS SHALL BE SCALED FROM THE DRAWINGS
  - ALL LEVELS ARE IN METRES AND ARE TO MALIN HEAD DATUM
  - ALL COORDINATES ARE IN METRES AND ARE TO IRISH TRANSVERSE MERCATOR
  - DRAWINGS ARE TO BE READ IN CONJUNCTION WITH THE SPECIFICATION

- LEGEND**
- EXTENT OF WORKS
  - SURFACE A: PROPOSED BITUMINOUS SURFACED GREENWAY, TO APPENDIX 7/1
  - SURFACE B: PROPOSED GRIT SURFACE, TO APPENDIX 7/1
  - SURFACE C: RESURFACED GRIT SURFACE, TO APPENDIX 7/1
  - SURFACE D: PROPOSED BITUMINOUS INLAY TO APPENDIX 7/1
  - SURFACE E: PROPOSED BITUMINOUS INLAY TO APPENDIX 7/1
  - SURFACE F: PROPOSED BITUMINOUS INLAY TO APPENDIX 7/1
  - TACTILE PAVING AS PER 5155640/HTR/SCD/0004 (UNCONTROLLED JUNCTION)
  - TACTILE PAVING AS PER 5155640/HTR/SCD/0004 (LADDER & TRAMLINE)
  - NARROWED / WIDENED GREENWAY
  - BITUMINOUS FOOTWAY TO APPENDIX 11/1
  - PROPOSED EARTHWORKS / VERGE
  - EXISTING SURFACED AREA TO BE RETAINED
  - RE-INSTALL PAVING BLOCKS
  - ROYAL CANAL
  - PROPOSED CONCRETE FOOTWAY / BUILD-OUT TO APPENDIX 11/1
  - EXISTING KERB TO BE RETAINED
  - TYPE A PRECAST CONCRETE KERB TO CC-SCD-01101 (WITH 125mm UPSTAND)
  - TYPE B PRECAST CONCRETE KERB TO CC-SCD-01101 (WITH 160mm UPSTAND)
  - TYPE C PRECAST CONCRETE KERB TO CC-SCD-01101 (WITH 80mm UPSTAND SPLAYED AT 45 DEG.)
  - TYPE D PRECAST DROPPED KERB TO CC-SCD-01103 (WITH 0mm UPSTAND)
  - VEHICULAR DROPPED KERB (25mm UPSTAND)
  - RANDOM RUBBLE MASONRY CAPPING TO EXISTING HARBOUR WALL, TO APPENDIX 24/1
  - KASSEL KERB AS PER DRAWING 5155640/HTR/SCD/0015. (160mm UPSTAND)
  - HEDGE - TO APPENDIX 30/1
  - PROPOSED TRAFFIC SIGNS, TO APPENDIX 12/1
  - PROPOSED VERGE DELINEATORS TO APPENDIX 12/2 OF THE SPECIFICATION
  - PROPOSED CYCLE LANE SEPARATORS TO APPENDIX 12/2 OF THE SPECIFICATION
  - PENCIL BOLLARDS TO APPENDIX 12/2
  - PROPOSED TIMBER POST & RAIL FENCE TO TII CC-SCD-00301
  - PROPOSED TIMBER POST AND TENSION MESH FENCE TO TII CC-SCD-00320
  - PROPOSED RAILING TYPE 1 TO APPENDIX 4/2
  - PROPOSED RAILING TYPE 2 TO APPENDIX 4/2 OF
  - PEDESTRIAN GUARDRAIL TO APPENDIX 4/2
  - PROPOSED GREENWAY GATE
  - SINGLE STEEL FIELD GATE TO TII-SCD-00309 (TYPE Z)
  - PB PROPOSED PARK BENCH AS PER APPENDIX 30/2
  - FS RELOCATED FISHING STAND
  - MEM RELOCATED MEMORIAL
  - PT PROPOSED PICNIC TABLE AS PER APPENDIX 30/2
  - CC PROPOSED CYCLE COUNTERS AS PER APPENDIX 30/2
  - MR PROPOSED MOORING RING TO APPENDIX 30/2
  - CS PROPOSED CYCLE STANDS TO APPENDIX 30/2
  - CRS PROPOSED CYCLE REPAIR STAND AS PER APPENDIX 30/2
  - LB PROPOSED LITTER BIN AS PER APPENDIX 30/2
  - PROPOSED LIGHTING COLUMNS AS PER APPENDIX 13/1 (TYPE A)
  - PROPOSED LIGHTING COLUMN (ROOTING ONLY) AS PER APPENDIX 13/1 (TYPE A)
  - PROPOSED LIGHTING UNITS AS PER APPENDIX 13/1 (TYPE B)
  - PROPOSED LIGHTING COLUMN AS PER APPENDIX 13/1 (TYPE C)
  - PROPOSED LIGHTING COLUMN AS PER APPENDIX 13/1 (TYPE E)
  - PROPOSED LIGHTING COLUMN AS PER APPENDIX 13/1 (TYPE F)
  - PROPOSED TABLE TOP RAMP

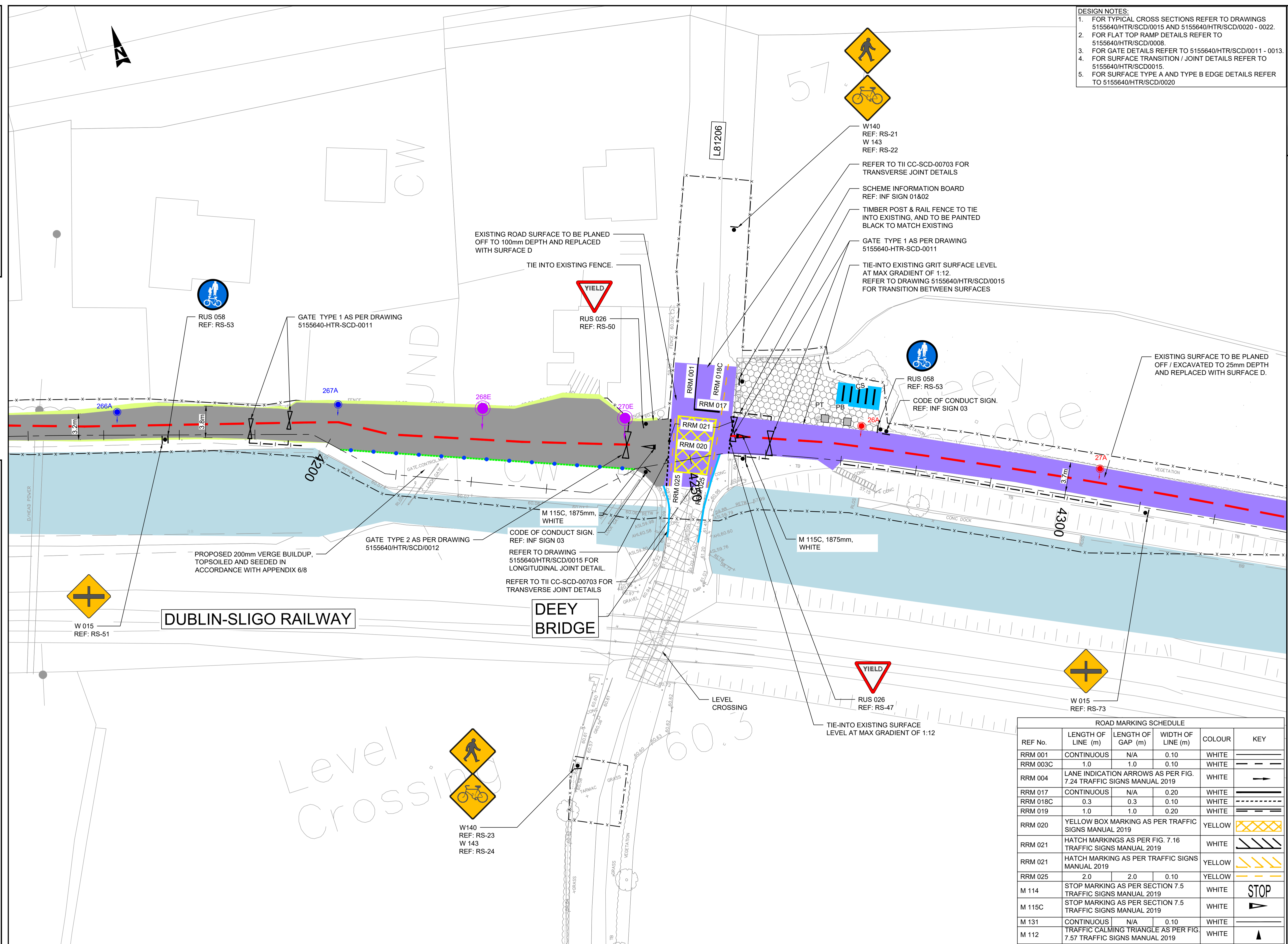

**ROAD MARKING SCHEDULE**

REF No.	LENGTH OF LINE (m)	LENGTH OF GAP (m)	WIDTH OF LINE (m)	COLOUR	KEY	
RRM 001	CONTINUOUS	N/A	0.10	WHITE	—	
RRM 003C	1.0	1.0	0.10	WHITE	—	
RRM 004	LANE INDICATION ARROWS AS PER FIG. 7.24 TRAFFIC SIGNS MANUAL 2019				WHITE	→
RRM 017	CONTINUOUS	N/A	0.20	WHITE	—	
RRM 018C	0.3	0.3	0.10	WHITE	—	
RRM 019	1.0	1.0	0.20	WHITE	—	
RRM 020	YELLOW BOX MARKING AS PER TRAFFIC SIGNS MANUAL 2019				YELLOW	☐
RRM 021	HATCH MARKINGS AS PER FIG. 7.16 TRAFFIC SIGNS MANUAL 2019				WHITE	▨
RRM 021	HATCH MARKING AS PER TRAFFIC SIGNS MANUAL 2019				YELLOW	▨
RRM 025	2.0	2.0	0.10	YELLOW	—	
M 114	STOP MARKING AS PER SECTION 7.5 TRAFFIC SIGNS MANUAL 2019				WHITE	STOP
M 115C	STOP MARKING AS PER SECTION 7.5 TRAFFIC SIGNS MANUAL 2019				WHITE	▵
M 131	CONTINUOUS	N/A	0.10	WHITE	—	
M 112	TRAFFIC CALMING TRIANGLE AS PER FIG. 7.57 TRAFFIC SIGNS MANUAL 2019				WHITE	▴
RRM 030	BUS STOP MARKINGS AS PER SECTION 7.7 OF THE TRAFFIC SIGNS MANUAL 2019				WHITE	▭

File: 5155640\_HTR\_DR\_0121.dwg  
Date: Oct 02, 2023 - 10:41am  
Plotted by: RÓrighnigh

© ORDNANCE SURVEY IRELAND LICENSE No. AR 0082521  
ORDNANCE SURVEY IRELAND & GOVERNMENT OF IRELAND

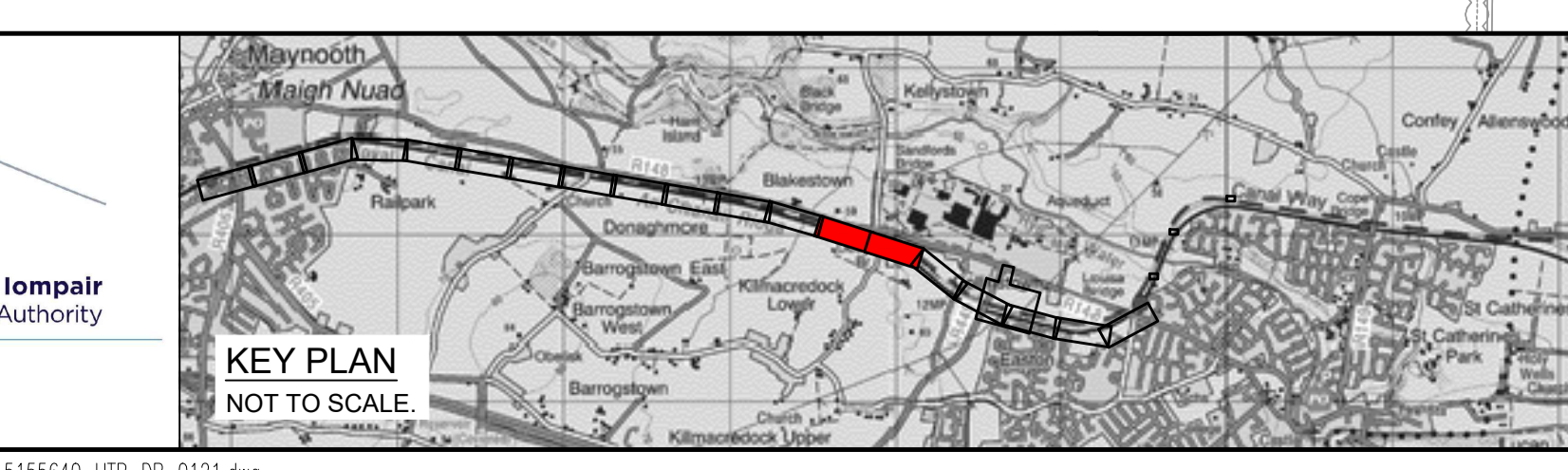

Rev	Description	By	Date	Chk'd	Auth
-	ISSUED FOR TENDER	RG	15.09.23	DR	DM

**ATKINS**  
Member of the SNC-Lavalin Group

Atkins House, 150-155 Atrside Business Park, Swards, Co. Dublin  
Tel (+353) 01 810 8000 Fax (+353) 01 810 8001

Unit 2B, 2200 Cork Airport Business Park, Cork  
Tel (+353) 021 429 0300 Fax (+353) 021 429 0360

1st Floor Technology House Parkmore Technology Park, Galway  
Tel (+353) 091 786 050 Fax (+353) 091 779 830

Client: **KILDARE COUNTY COUNCIL**

Project: **THE ROYAL CANAL GREENWAY MAYNOOTH TO CONFEEY**

Title: **GENERAL ARRANGEMENT DEEY BRIDGE**

Original Scale: 1:250 at A1, 1:500 at A3  
Design/Drawn: RG, Checked: ST, Authorised: DM  
Date: 05.10.17, Date: 05.10.17, Date: 05.10.17

Status: T, Drawing Number: 5155640 /HTR / DR / 0121, Rev: -